

DRIVE AXLE

SERVICE TOOLS – OTHER SUPPLIER

Description	Part Number	Page
SNAP-ON 3-JAW PULLER	CG273	3

SERVICE PRODUCTS

Description	Part Number	Page
SUSPENSION GREASE	293 550 033	4

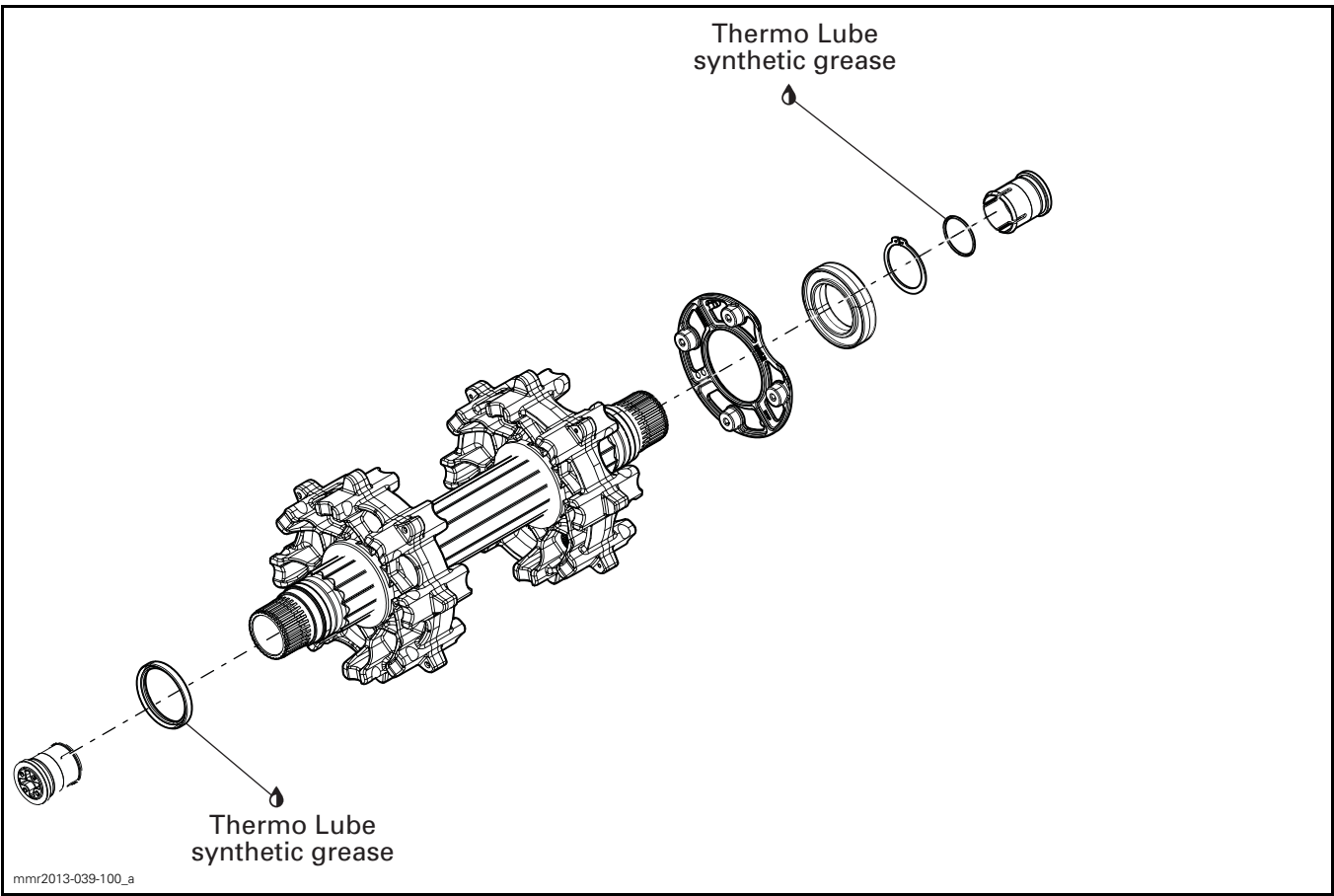

GENERAL

During assembly/installation, use torque values and service products as in the exploded view.

Clean threads before applying a threadlocker. Refer to *SELF-LOCKING FASTENERS* and *LOCTITE APPLICATION* at the beginning of this manual for complete procedure.

WARNING

Torque wrench tightening specifications must be strictly adhered to. Locking devices must be replaced with new ones when removed (e.g.: locking tabs, elastic stop nuts, cotter pins, etc.).

PROCEDURES

DRIVE AXLE

Drive Axle Removal

1. Remove the rear suspension. Refer to *REAR SUSPENSION* subsection.
2. Remove the chaincase cover. Refer to *CHAINCASE* subsection.
3. Release tension from drive chain by unscrewing the tensioner adjustment screw.

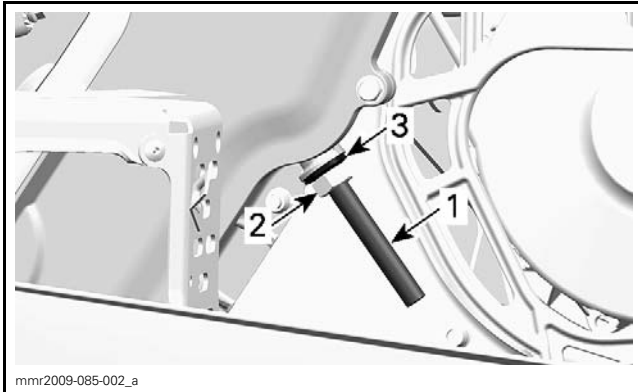

1. Tensioner adjustment screw
2. Lock nut
3. Washer with rubber surface

4. Remove the lower sprocket circlip.

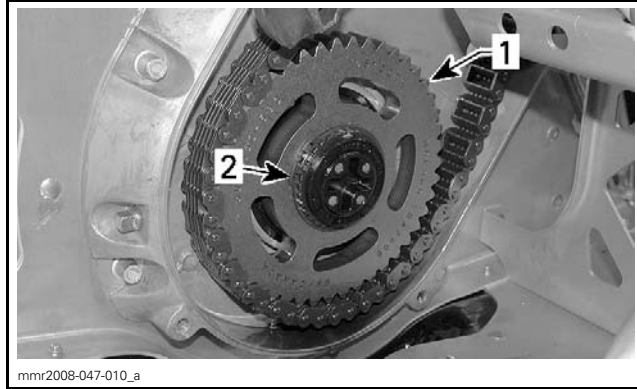

1. Lower sprocket
2. Circlip

5. Remove lower gear and drive chain.
6. Remove the caliper. Refer to *BRAKE* subsection.
7. From underneath of vehicle, turn the LH bearing flange counterclockwise to unlock it from frame.

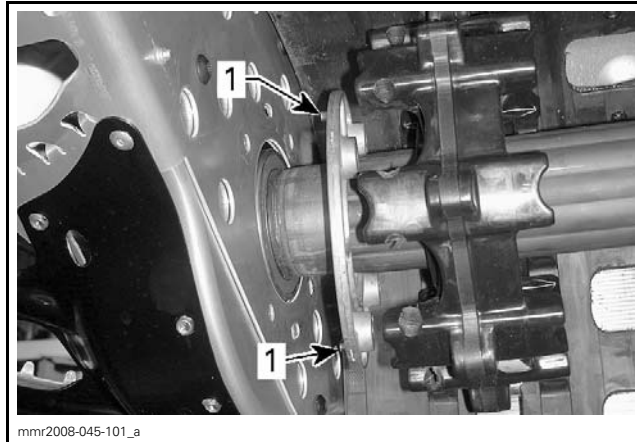

TYPICAL

1. Bearing flange locking tabs

8. Release drive axle sprockets from track and at the same time, push the drive axle toward the LEFT side.
9. Move the drive axle towards the right side to remove it from vehicle.

Drive Axle Inspection

Check if bearing turns smoothly and freely. Replace bearing if necessary.

Check if bearing seals are damaged. Replace bearing seals if necessary.

Check if the bearing flange is cracked, bent or otherwise damaged. Replace if required.

Replace drive axle if one of the following situations is detected:

- Cracked, worn or damaged drive axle
- Worn or damaged drive axle splines

- Worn or damaged sprockets
- Worn bearing journal.

Drive Axle Bearing Removal

1. Remove O-ring.

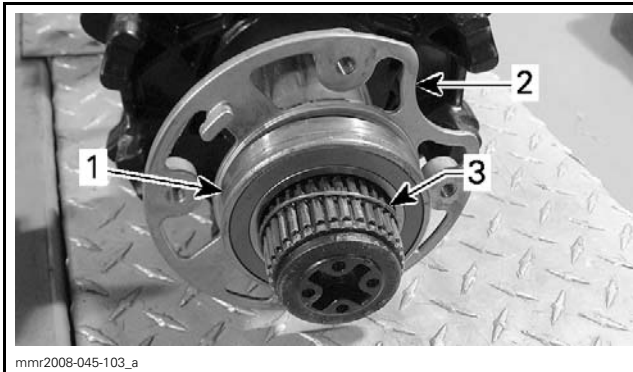

1. Drive axle bearing
2. Bearing flange
3. O-ring

2. Using a 3-jaw puller such as the SNAP-ON 3-JAW PULLER (P/N CG273), remove the drive axle bearing.

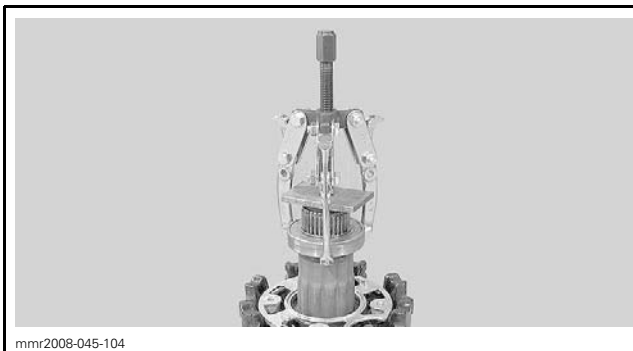

3. Remove the bearing flange.

Drive Axle Bearing Installation

1. Install bearing flange on drive axle.

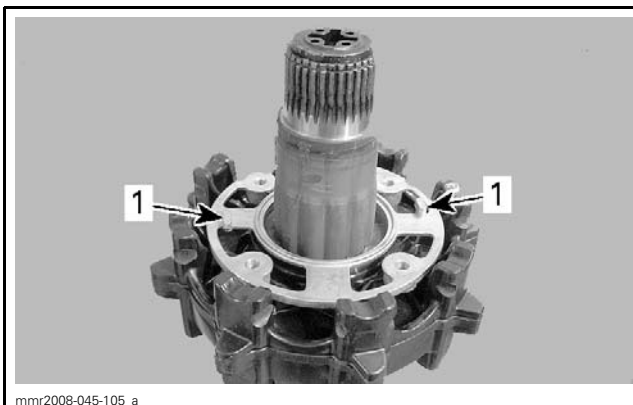

1. Locking tabs outwards

2. Using a press and a suitable pipe, push the bearing onto drive axel.

NOTICE Always push the bearing by inner race.

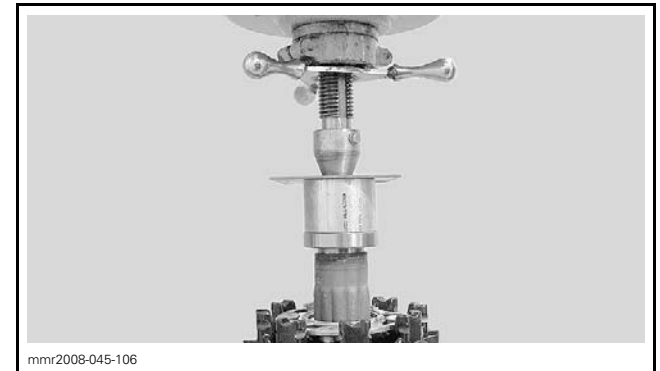

Drive Axle Installation

The installation is the reverse of the removal procedure. However, pay attention to the following.

1. Insert drive axle and lock the bearing flange on frame.

NOTE: Ensure bearing flange is properly locked. Tabs must be properly inserted in frame slots.

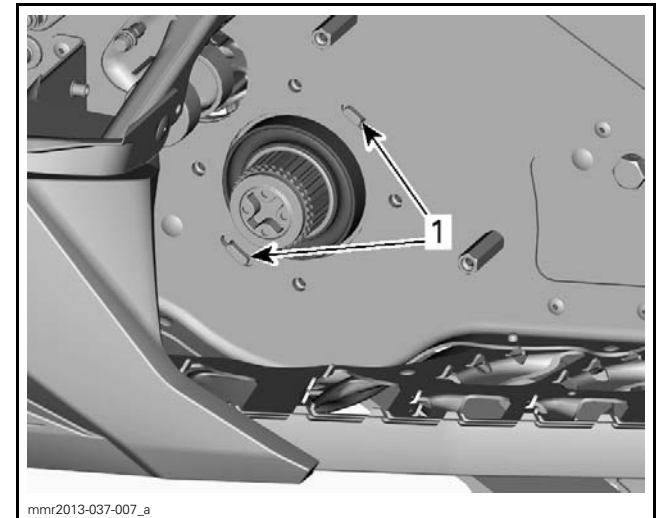

VIEW FROM OUTSIDE FRAME

1. Bearing flange locking tabs

2. Install the caliper and the disc brake. Refer to *BRAKE* subsection for the specific procedure.
3. Install all other removed parts. Refer to appropriate subsections.

MAGNETIC CAPS

Magnetic Cap Removal

1. For the LH cap, remove brake disc protective cover. Refer to *BRAKE* subsection.

Subsection XX (DRIVE AXLE)

2. For the RH cap, remove the chaincase cover.
Refer to *CHAINCASE* subsection.
3. Using two screwdrivers or pliers, pry or pull the magnetic cap out of drive axle end.
4. Discard the magnetic cap.

Magnetic Cap Installation

1. Apply SUSPENSION GREASE (P/N 293 550 033) on O-ring.
2. Insert **NEW** magnetic cap in drive axle.
3. Install all other removed parts.